

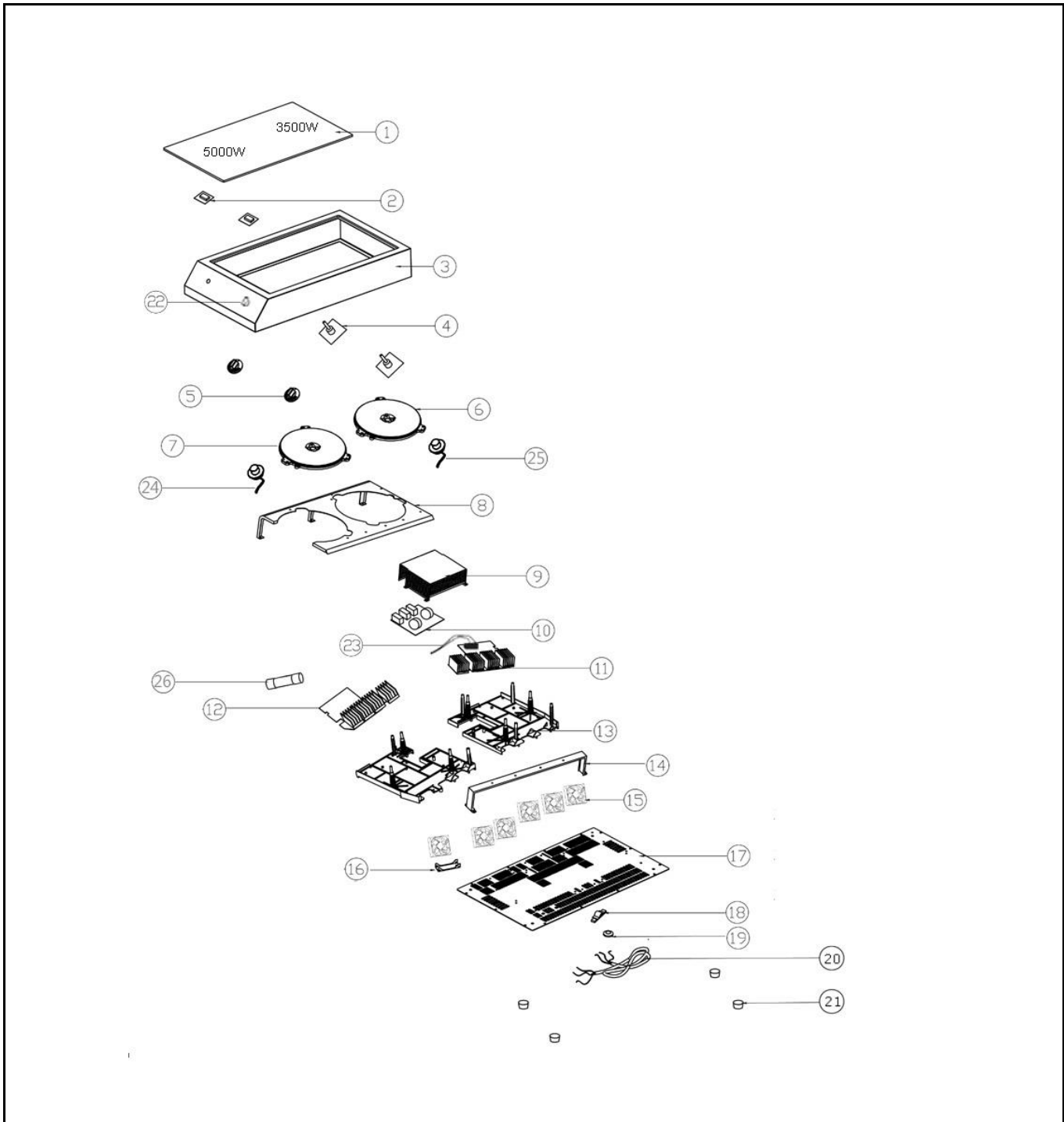

Drawing

 <p><b>Hendi B.V.</b> Steenoven 21 3911 TX Rhenen The Netherlands</p>	<p><b>Batch #</b></p>	<p><b>Appliance part#</b></p>
	<p>HK170405 until HK036819</p>	<p><b>239346</b></p>
	<p><b>Description</b></p>	
	<p>Induction Cooker Model 7000</p>	

<p><b>Date</b></p>	<p>21-08-2020</p>	<p><b>Revision #</b></p>	<p>1.0</p>
<p><b>Revision</b></p>	<p>First Bill of Materials (BOM)</p>		



### Bill of materials (BOM)

 <b style="font-size: 24px; font-weight: bold;">HENDI</b> <small>FOOD SERVICE EQUIPMENT</small>  <b>Hendi B.V.</b> Steenoven 21 3911 TX Rhenen The Netherlands	<b>Batch #</b>	<b>Appliance part#</b>
	HK170405 until HK036819	239346
	<b>Description</b>	
Induction Cooker Model 7000		

<b>Date</b>	21-08-2020	<b>Revision #</b>	1.0
<b>Revision</b>	First Bill of Materials (BOM)		

Item	Description	Part#	Quantity	Remark	Picture
1	Ceramic Glass plate	nss	1	Available as 944844	
2	Main Control PCB	nss	1	Available as 944851	
3	Upper Housing	nss	1	Available as 944844	
1 + 3	Upper Housing with Ceramic Glass	944844	1	Incl. Item 1 and 3	
4	Control PCB (Knob)	nss	2	Available as 944851	
2 + 4	Control Panel Complete	944851	1	Incl. Item 2 and 4	
5	Knob	919453	2		
6	Induction Coil (Back)	944868	1	3500 Watts	
7	Induction Coil (Front)	944875	1	5000 Watts	
9	Protective Bracket Filter PCB	n/a	1		
10	EMC Filter PCB	944882	1		
11	Main PCB (Back)	944899	1	3500 Watts	
12	Main PCB (Front)	944905	1	5000 Watts	
13	PCB Mountin Bracket	n/a	2		
14	Fan Mounting Bracket (5 pcs)	n/a	1		
15	Fan	901441	6		
16	Fan Mounting Bracket (1 pcs)	n/a	1		
17	Bottom Plate	n/a	1		
18	Power Cord Retention	n/a	1		
19	Power Cord Protector	n/a	1		
20	Power Cord	n/a	1	H07RN-F 5G1,5MM	
21	Foot	944912	4		
22	Protection Nut Control PCB	n/a	2		
23	Wire Bridge Main PCB	n/a	2		
24	Sensor A	944929	1		
25	Sensor B	944936	1		
26	Fuse	n/a	2		

n/a -> not available

nss -> not sold separately

## Wiring diagram

 <p><b>Hendi B.V.</b> Steenoven 21 3911 TX Rhenen The Netherlands</p>	<b>Batch #</b>	<b>Appliance part#</b>
	HK170405 until HK036819	<b>239346</b>
	<b>Description</b>	
	Induction Cooker Model 7000	

<b>Date</b>	21-08-2020	<b>Revision #</b>	1.0
<b>Revision</b>	First Bill of Materials (BOM)		

